

# 751

Watch Battery  
Swiss Made

## Technical Data Sheet

### Specifications

Chemical system	Li / CuS
Nominal Voltage	2 V
Capacity	6 mAh, Discharge over 243 kΩ at 23°C to 1,2 V
Initial Voltage	≥ 2,15 V
Self Discharge at 23°C	< 1 % / year
Weight	~ 0,11 g

### Dimensions

Diameter	5,80 mm (0,228")
Height	1,28 mm (0,050")

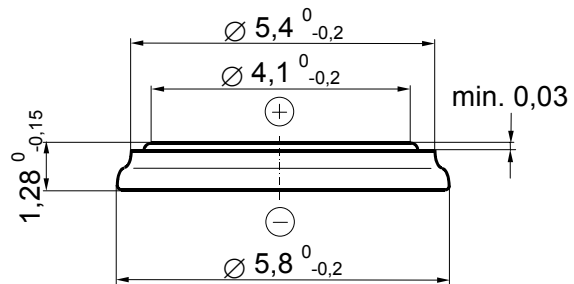

### Discharge Curve

Constant Load	243 kΩ
Temperature	23°C

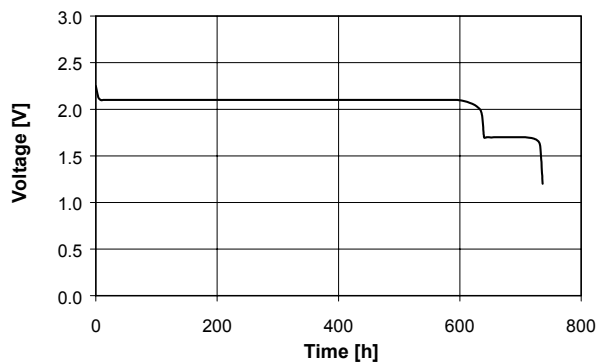

Rev. 44.02 07/02